

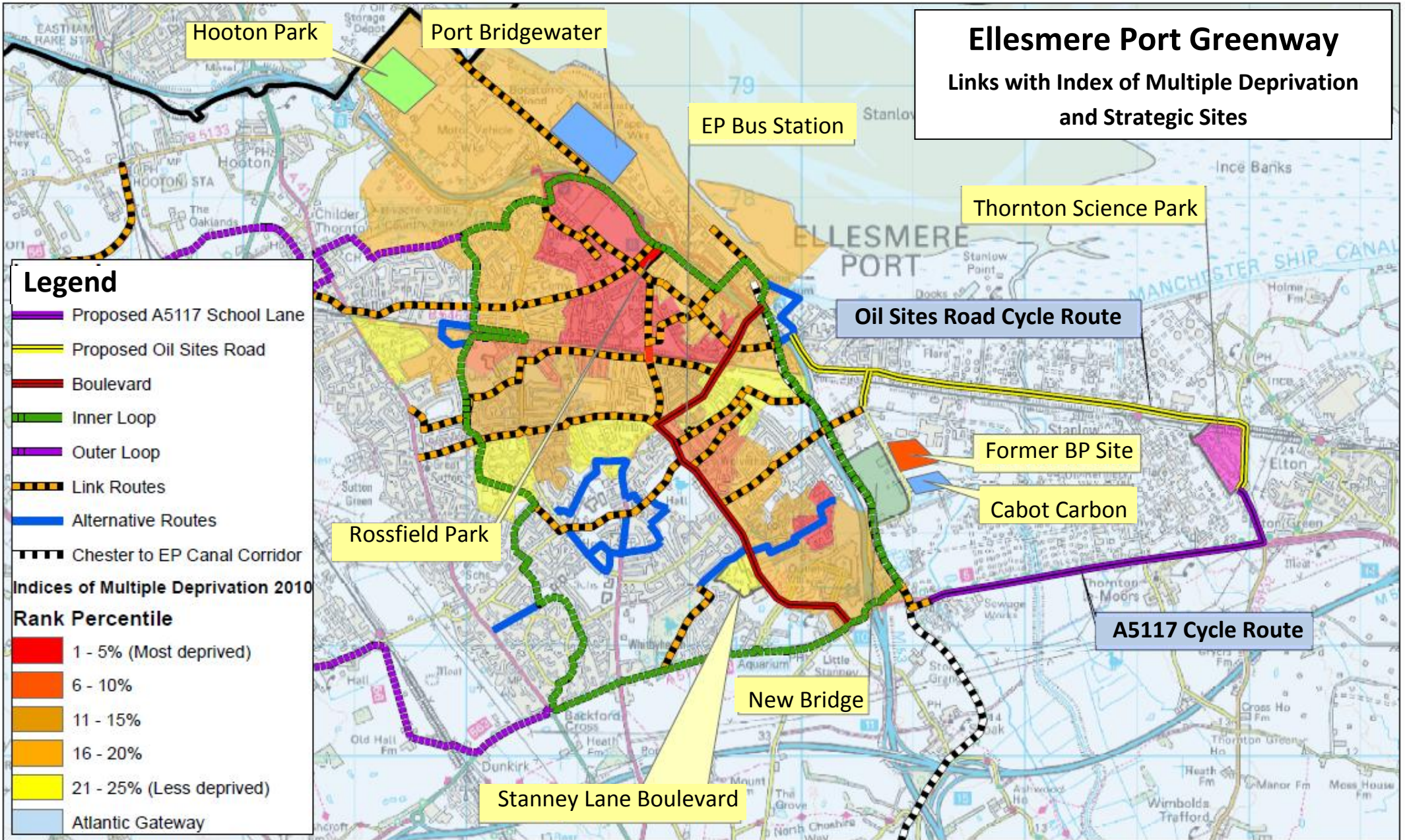

Cheshire West
and Chester

Appendix 2



Thornton Science Park
Existing and Proposed Cycle Measures

Map illustrating cycle network links with the Index of Multiple Deprivation in Ellesmere Port, and proposed cycle routes along Oil Sites Road and A5117 from Ellesmere Port to Thornton Science Park

Route Section No.	Kilometres	After Proposed Scheme Improvements
1	2.19	cycle route is off-road segregated cycle track
2	0.71	cycle route is off-road segregated cycle track
3	0.50	cycle route is off-road segregated cycle track
4	0.79	cycle route is off-road segregated cycle track
Total Cycle Route (km)	4.19	

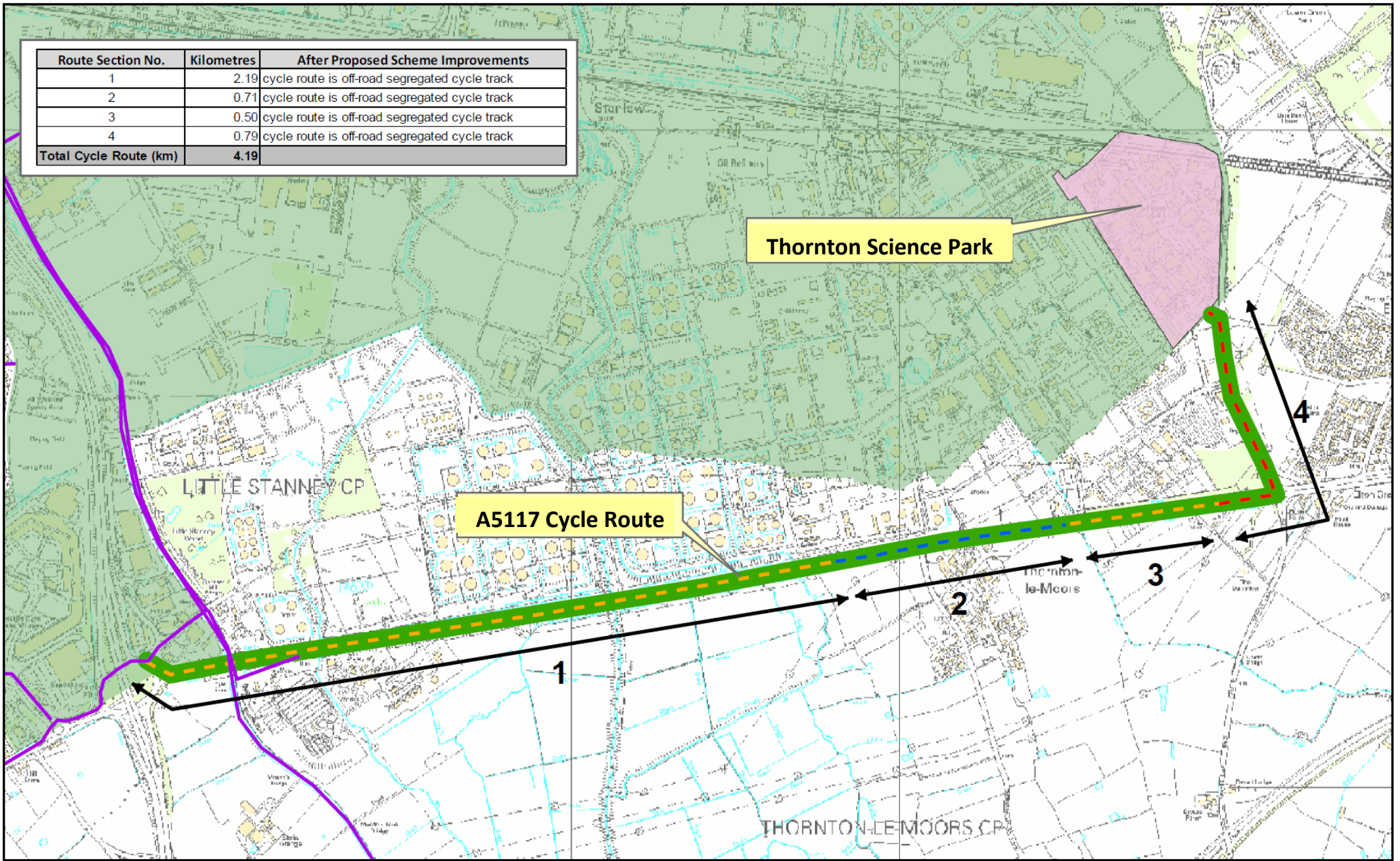

A517 Proposed Cycle Route Improvements

Map illustrating proposed A517 cycle route improvements between Cheshire Oaks, Ellesmere Port to Thornton Science Park

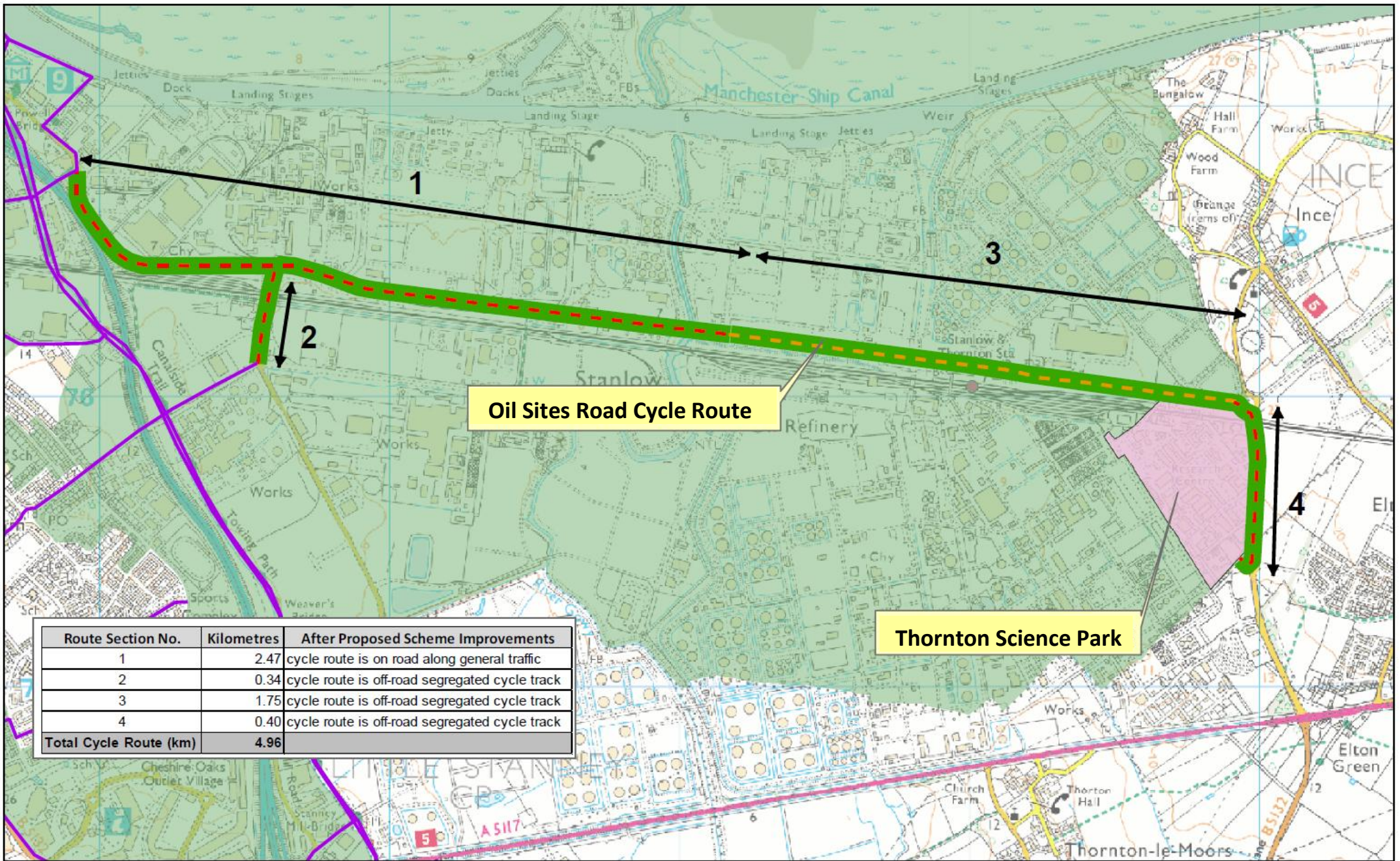

Route Section No.	Kilometres	After Proposed Scheme Improvements
1	2.47	cycle route is on road along general traffic
2	0.34	cycle route is off-road segregated cycle track
3	1.75	cycle route is off-road segregated cycle track
4	0.40	cycle route is off-road segregated cycle track
Total Cycle Route (km)	4.96	

Oil Sites Road, Proposed Cycle Route Improvements

Map illustrating proposed Oil Sites Road cycle route improvements between Ellesmere Port Town Centre to Thornton Science Park

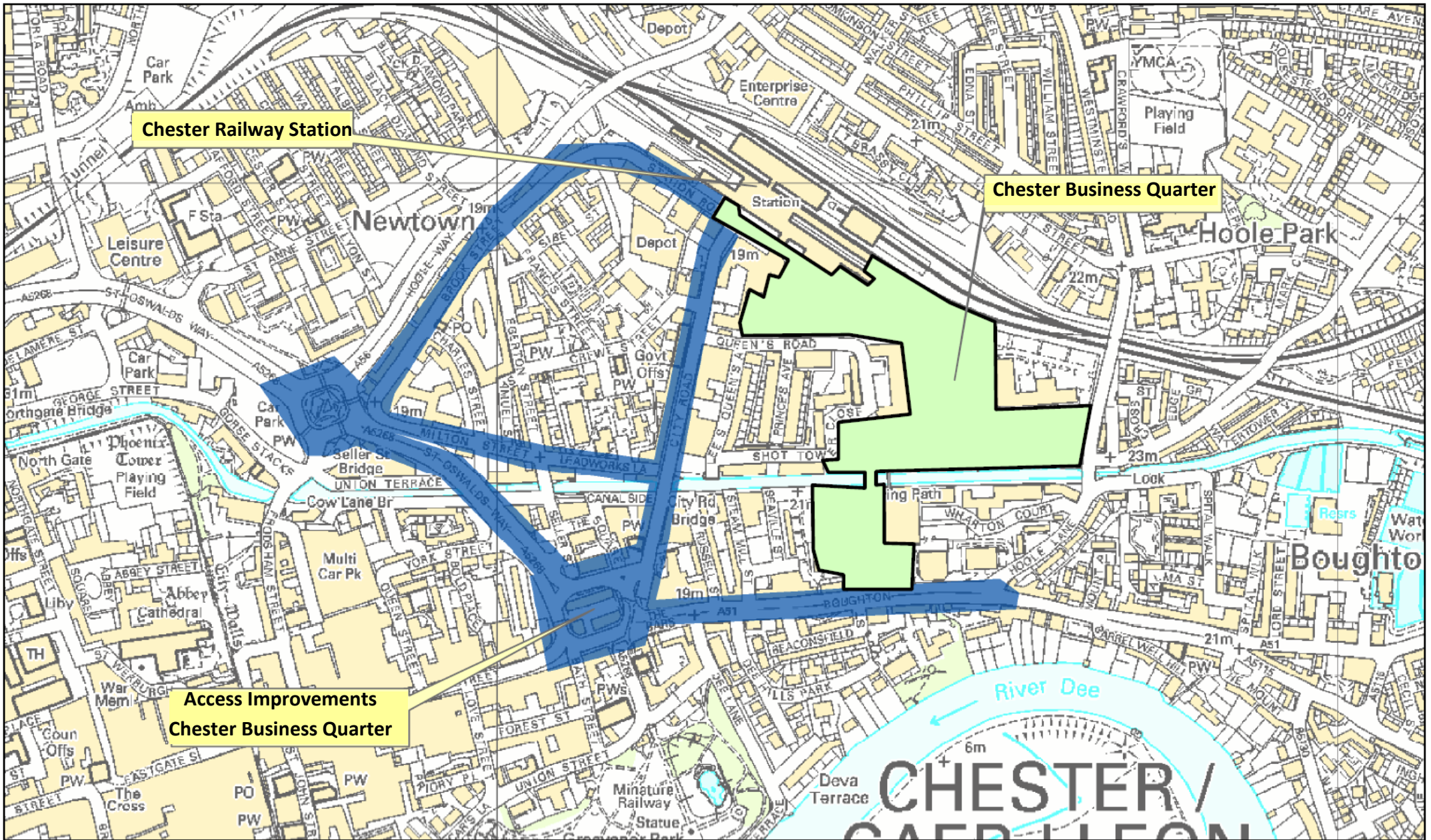

Chester Business Quarter, Access Improvements

Map illustrating proposed access improvements to Chester Business Quarter near Chester Railway Station, improvements include: crossings and cycle facilities

© Crown copyright and database rights 2014. Ordnance Survey 100049046.